



CABLE CLAMPS & CLIPS

FCRC
Flat Cable Routing Clamp

- Specifications:
- Material: UL94 V-2 Nylon 6/6
 - Color: Natural

- Features:
- Two part design: Cable clamp base and tension-locking cover (sold separately)
 - More than one cover can be mounted on base; for strain relief. Double back cable and secure with a second cover
 - Base is secured either with a #10 or #12 screw or adhesive

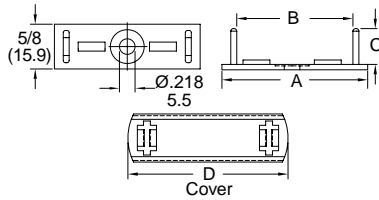

Base Item No.		A Ref.		B Ref.		C		Use Cover Item No.		D		Bulk Pack Qty.
Without Adhesive	With Adhesive	In	mm	In	mm	In	mm			In	mm	
FCRC-13B-4	FCRC-13B-4A-RT	2.040	51.7	1.620	41.2	0.500	12.7	FCRC-13C		2.240	56.8	100
FCRC-19B-4	FCRC-19B-4A-RT	2.720	69.1	2.310	58.7	0.500	12.7	FCRC-19C		2.920	74.2	100
FCRC-21B-4	FCRC-21B-4A-RT	2.980	75.7	2.550	64.8	0.500	12.7	FCRC-21C		3.170	80.5	100
FCRC-26B-4	FCRC-26B-4A-RT	3.660	93.0	3.240	82.3	0.500	12.7	FCRC-26C		3.860	98.0	100
FCRC-13B-6	FCRC-13B-6A-RT	2.040	51.7	1.620	41.2	0.750	19.1	FCRC-13C		2.240	56.8	100
FCRC-19B-6	FCRC-19B-6A-RT	2.720	69.1	2.310	58.7	0.750	19.1	FCRC-19C		2.920	74.2	100
FCRC-21B-6	FCRC-21B-6A-RT	2.980	75.7	2.550	64.8	0.750	19.1	FCRC-21C		3.170	80.5	100
FCRC-26B-6	FCRC-26B-6A-RT	3.660	93.0	3.240	82.3	0.750	19.1	FCRC-26C		3.860	98.0	100

FCLC / FCLCS
Flat Cable Loop Clip

- Specifications:
- Material: UL94 V-2 Nylon 6/6
 - Color: Natural

- Features:
- Allows for quick positive clamping of flat cable without the need for securing the clip to a board

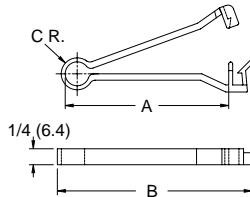

Item No.	A Max Cable Width		B Ref.		C Ref.		Bulk Pack Qty.
	In	mm	In	mm	In	mm	
FCLCS	1.500	38.1	2.000	50.8	0.230	5.8	500
FCLC	2.500	63.5	3.000	76.2	0.250	6.4	500

FCW
Cable Clamp on Adhesive Base

- Specifications:
- Material: Nylon 6/6
 - Color: Natural
- Features:
- Allows for quick positive clamping of flat cable up to 50 conductors wide
 - Adhesive base for quick installation
 - Latch allows cables to be added and removed

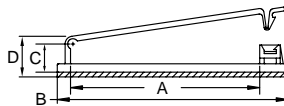

Item No.		Max # of Conductors	Depth		A		B		C Ref.		D Ref.		Bulk Pack Qty.
UL94 V-2	UL94 V-0		In	mm	In	mm	In	mm	In	mm	In	mm	
FCW-29-01	FCW-29-19	30	0.740	18.9	1.240	31.5	1.780	45.1	0.300	7.7	0.440	11.1	100
FCW-30-01	FCW-30-19	30	0.750	19.1	1.240	31.5	1.790	45.5	0.350	9.0	0.520	13.1	100
FCW-40-01	FCW-40-19	40	0.750	19.1	1.550	39.3	2.090	53.0	0.370	9.3	0.530	13.4	100
FCW-50-01	FCW-50-19	50	0.750	19.1	2.490	63.2	3.040	77.2	0.360	9.1	0.520	13.2	100
FCW-50H-01	FCW-50H-19	50	0.740	18.9	2.540	64.6	3.080	78.2	0.590	15.1	0.750	19.0	100

FCCA / FCCB
Arrowhead Mounted Cable Clamp

- Specifications:
- Material: UL94 V-2 Nylon 6/6
 - Color: Natural

- Features:
- Convenient releasable latch allows easy addition and removal of cables
 - Easily mounted into pre-drilled holes

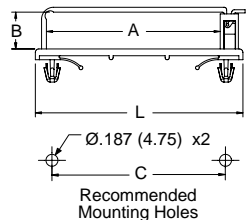
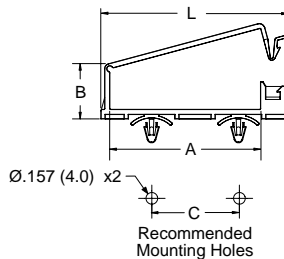

Figure 1

Figure 2

Item No.	Figure	L		A		B		C		Panel Thickness		Depth		Bulk Pack Qty.
		In	mm	In	mm	In	mm	In	mm	In	mm	In	mm	
FCCA-30A-01	1	2.560	65.0	2.100	52.0	0.750	19.1	1.180	30.0	0.030 - 0.079	0.8 - 2.0	0.390	10.0	100
FCCA-40A-01	1	2.640	67.0	5.100	53.4	0.640	16.4	1.580	40.0	0.030 - 0.079	0.8 - 2.0	0.390	10.0	100
FCCB-1	2	3.030	77.0	2.540	64.5	0.280	7.2	2.540	64.5	0.031 - 0.078	0.8 - 2.0	0.790	20.0	100
FCCB-2	2	3.030	77.0	2.540	64.5	0.540	13.7	2.540	64.5	0.031 - 0.078	0.8 - 2.0	0.790	20.0	100